



16 Hogg Avenue Salter Point, WA



4



2



4

## Make An Offer!

Enviably located in the prestigious Mt Henry Estate, amongst quality homes and overlooking abundant parklands, this architect-designed executive family abode, built by award-winning Atrium Homes, will leave you wanting for nothing.

A striking facade and commanding street presence set the tone for the number of features and quality of finishes which await you inside. Boasting over 370m<sup>2</sup> of leisure and living space across two impressive levels, the cleverly designed family-friendly floor plan provides room for everyone to enjoy. There are formal and informal areas, a theatre room, a teenagers or parents retreat and a magnificent designer kitchen highlighted by black granite benchtops

**Property Type:** House  
**Price:** SUIT BUYERS IN THE \$1.2M  
**Land size:** 450 Square Metres  
**Building size:** 374.5 Square Metres  
**Water rates:** \$1,336.00/year (approx)  
**Council Rates:** \$3,359.00/year (approx)



**James Thompson**  
 Senior Sales Executive  
 0421 677 856  
 james@bourkes.com.au

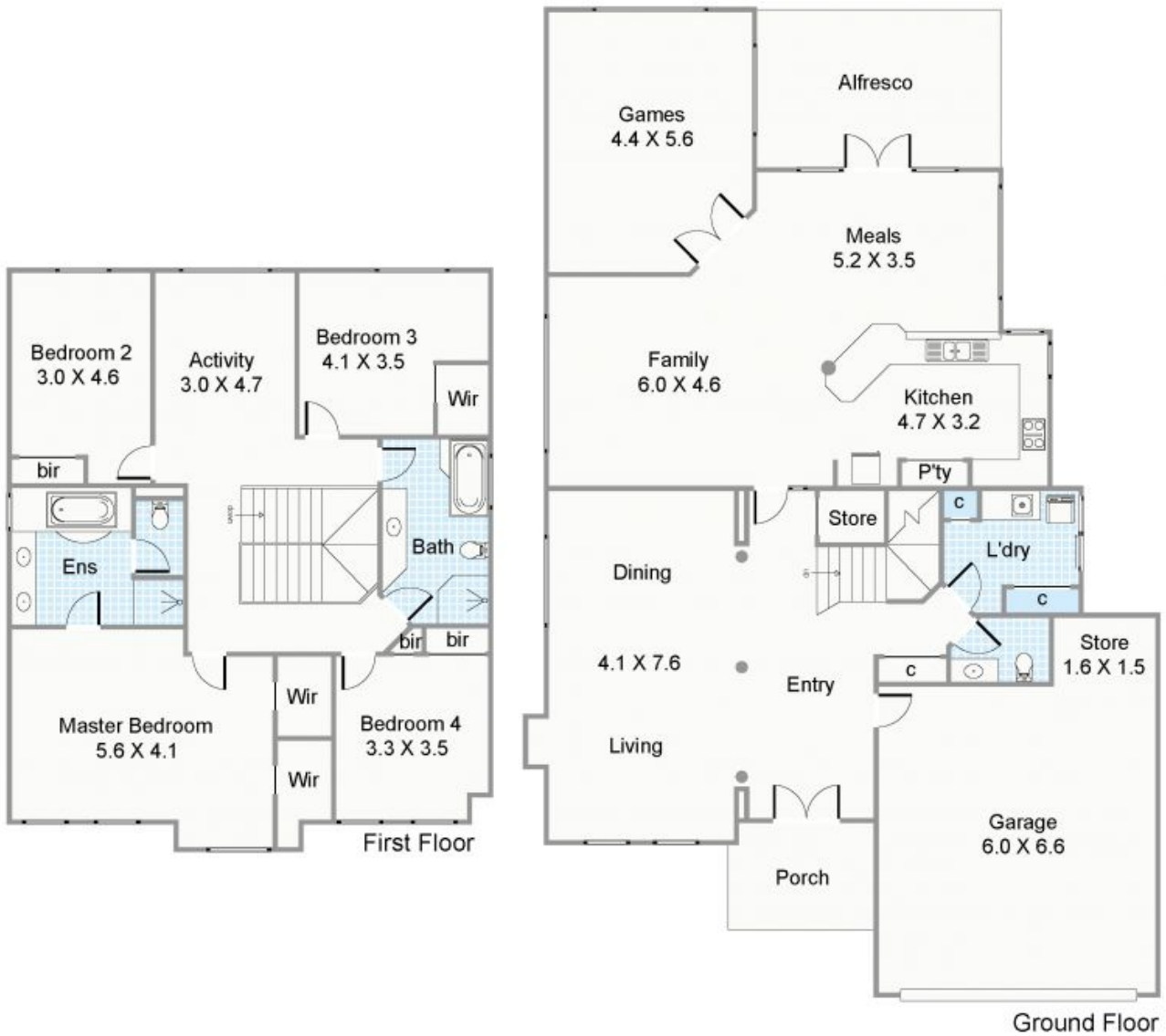

Approximate Areas

GROUND FLOOR

Residence: 168.92m<sup>2</sup>

Garage: 45.87m<sup>2</sup>

Alfresco: 18.37m<sup>2</sup>

Porch: 6.51m<sup>2</sup>

FIRST FLOOR

Residence: 134.83m<sup>2</sup>

Total Area: 374.50m<sup>2</sup>

All measurements are estimates  
All dimensions are in metres.  
Plans are for demonstration only.  
[www.cribcreative.com.au](http://www.cribcreative.com.au)



16 Hogg Avenue, Salter Point