



11 Wagstaff Road Redcliffe, WA



Second Chance!!

If you missed out the first time, an opportunity exists for you to snap up this beauty!

Be prepared to raise your expectations as you walk through this large, single level contemporary residence, with the essence of family and entertaining at the core of its design.

The thoughtful floorplan, combined with the many living options this home has to offer, makes this the ideal place to call home. Built in 2001 by Dale Alcock to a demanding and detailed specification, this home boasts an impressive list of features and will provide the lucky buyer with luxury, space and level of quality that is hard to find in this location.

Nestled in Ascot Gardens Estate, this gorgeous home is ideally

Property Type: House
Price: Sold - \$590,000
Land size: 575 Square Metres
Building size: 204 Square Metres
Water rates: \$1,383.00/year (approx)
Council Rates: \$1,844.00/year (approx)



Kathryn Perin
 Sales Executive
 0405 709 763
 kathryn@bourkes.com.au

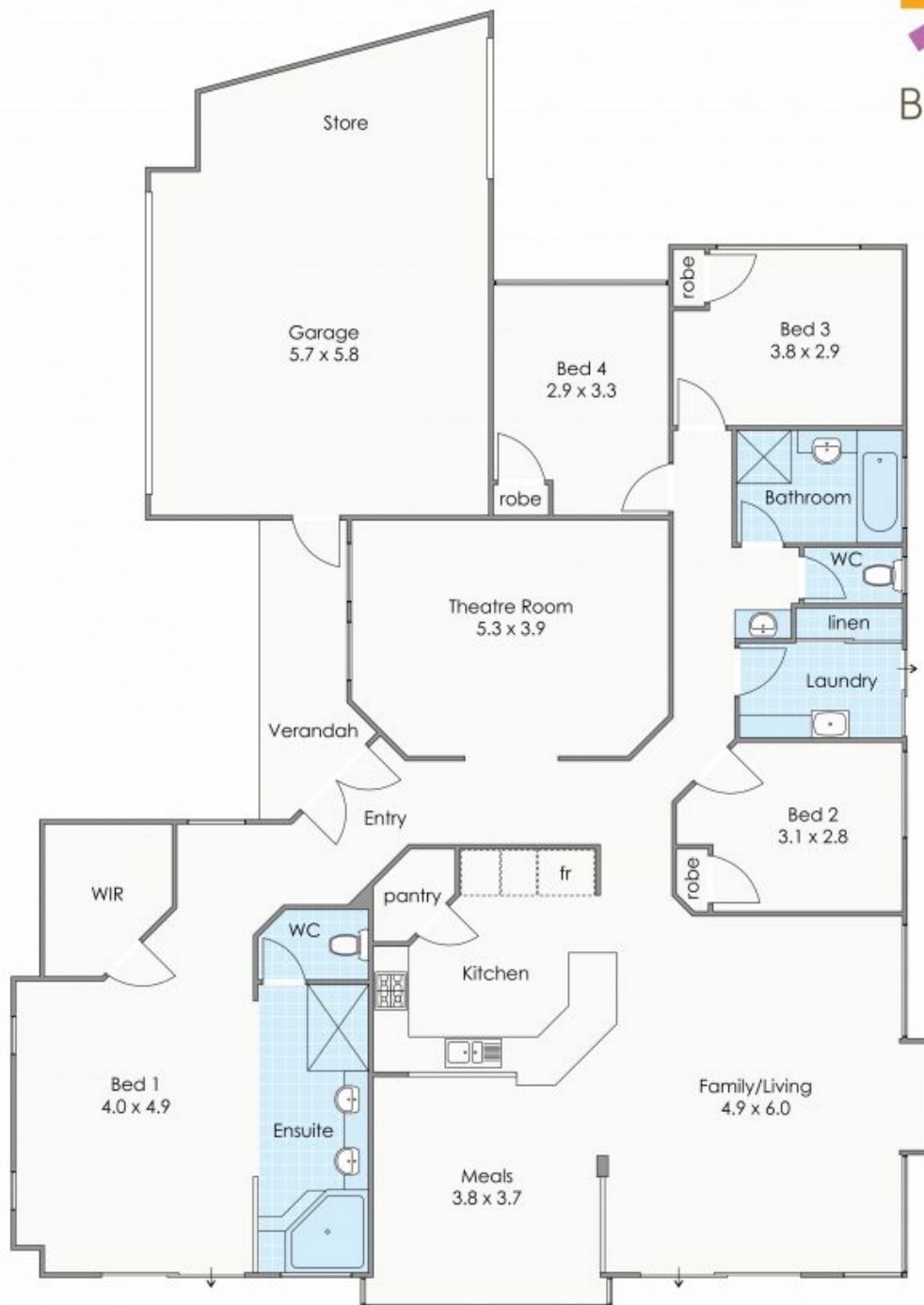

Approximate Areas

House:	205m ²
Garage/Store:	45m ²
Verandah:	6m ²
Total area:	256m ²

These plans have been produced for marketing purposes and are approximate only. They are not suitable for other uses.
www.cribcreative.com.au

11 Wagstaff Road, Redcliffe